



*New room design for the Swan (758 guest rooms)*

Renovations complete, ready to enjoy

### Guestrooms

**Rate \$159;** Additional person \$25 – *lower cost than economy hotel, plus no taxi fees needed*

Special rates offered 3 days prior & 3 days after the meeting dates – *for a wonderful family vacation*

Lower-priced evening tickets to Disney parks available for conference attendees

Disney property guests eligible for extended park hours and free shuttle service to the parks

Hotel Resort Fee \$0 – waived for ICTAC - *Includes unlimited local calls and 800 calls up to 60 min., long distance access, complimentary bottled water daily, high speed internet access, and unlimited admission to fitness centers*

## Global Collaboration

### ICTAC Executive Committee 2015

**President:** Wim de Klerk, The Netherlands

**Secretary:** Prof. Ranjit Verma, India

**Treasurer:** Dr. Pierre le Parlouer, France

**Membership Secretary:** Dr. Junko Morikawa, Japan

**Web:** [www.ictac.org](http://www.ictac.org)

### NATAS Executive Council 2016

**President:** Chris Li, Drexel University

**Vice-President:** Queenie Kwok, NRCan  
Canadian Explosives Research Laboratory

**Secretary:** Holly Salerno, Dupont  
Experimental Station

**Treasurer:** Steve Sauerbrunn, University of  
Delaware

**Executive Councilor:** Peggy Cebe, Tufts  
University

**Web:** [www.natasinfo.org](http://www.natasinfo.org)



Please join us at the Swan and  
Dolphin in Orlando, Florida

August 14<sup>th</sup> – August 19<sup>th</sup>, 2016

# ICTAC 2016

*International Confederation  
for Thermal Analysis and  
Calorimetry*



**ICTAC 2016**

Hosted by the North American  
Thermal Analysis Society

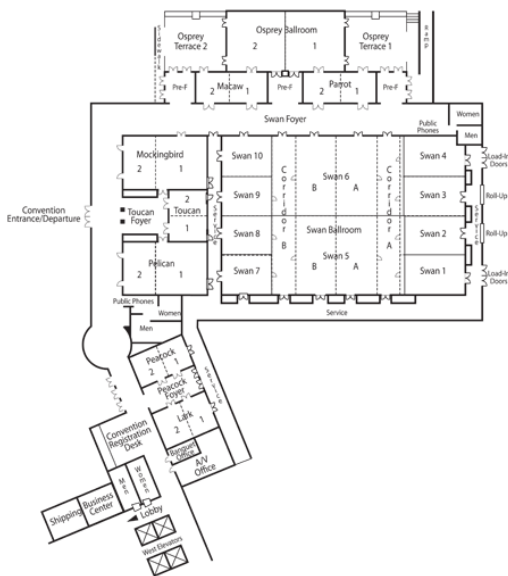

## Meeting Spaces are Spacious and Flexible

### General schedule:

- Poster session and welcome mixer Sunday evening
- Presentations ~8AM to 5PM daily, concluding with lunch on Friday
- ~~Three~~ **Four** concurrent sessions!
- Special activity with entertainment being planned for Wednesday afternoon and evening
- Awards Banquet Thursday evening
- Plenary session at start of each half day
- 40-minute featured paper at start of each session (as selected by session co-chairs)
- 20-minute contributed papers (including question period)

### Conference Organizers:

Chair: Tina Adams Co-chair: Prof. Bob Howell

Program Co-chairs: Eric Schoch (Americas), Riko Ozao (Asia), & Crisan Popescu (Europe)

### Technical Sessions in Program:

**Biomaterials, Biopolymers**

**Energetic Materials and Thermal Hazards**

**Fast Scanning Methods**

**Food Technology**

**Fuels and Biofuels**

**Glasses & Thermosets**

**High Temperature Thermal Analysis**

**Inorganic Materials**

**Instrumentation and Methods**

**Kinetics and Catalysis**

**Lifetime Prediction**

**Materials Processing**

**Natural Products**

**Personal Care**

**Pharmaceuticals**

**Polymer Phase Transformation**

**Polymer Stability**

**Process Safety**

**Pyrolytic Methods**

**Rheology and Viscoelasticity**

**Standards**

**Thermal Transport**

**Thermoelectric Properties**

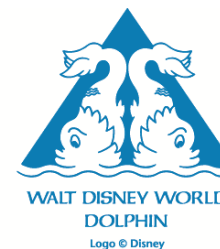

*In the heart of Walt Disney World Resort, about 20 minutes from Orlando International Airport*

### Walt Disney World Swan and Dolphin

1500 Epcot Resorts Boulevard

P.O. Box 22653

Lake Buena Vista, FL 32830

USA [www.swandolphin.com](http://www.swandolphin.com)

*Make your reservations now: Link on the NATAS website under Conferences – ICTAC 2016*

### To/From Airport:

**Mears** shuttle every hour (on the ½ hour): Round trip pricing with coupon \$37 (adult), \$28 (age 4-11), free (under age 3) ... [coupon and portal links now available on the NATAS website \[www.natasinfo.org\]\(http://www.natasinfo.org\)](#) (Taxi: approx. \$60.00)

**More than 300 abstracts!**

**Registration portal open**

*Full conference fee \$975 members of ICTAC or NATAS, \$1075 non-members; post-doc \$425; students \$375; 1-day options available*

*(Early rate deadline was June 1<sup>st</sup>)  
Registrations will be taken up until the day of the conference*